



Document reference ID : 5412

# Licensing Application Summary

## Transfer of Controlling Interest

<b>License ID:</b>	5040
<b>Application ID:</b>	5412
<b>Applicant Name:</b>	Chattermark Llc
<b>License Type applied for:</b>	Restaurant Eating Place License (REPL) (AS 04.09.210)
<b>Application Status:</b>	In Review
<b>Application Submitted On:</b>	04/02/2025 08:11 AM

## Entity Information

---

<b>Business Structure:</b>	Limited liability company
<b>FEIN/SSN Number:</b>	274035197
<b>Alaska Entity Number (CBPL):</b>	131648

## Entity Contact Information

---

<b>Entity Address:</b>	1120 E Huffman 24 PMB 416, Anchorage, AK, 99515, USA
------------------------	--

## Initial Application Information

---

<b>Authority Type:</b>	I am authorized user by the designated licensee with binding authority
<b>Legal First Name:</b>	Charles
<b>Legal Last Name:</b>	Jackson

**Email Address:** railwaycantina@yahoo.com

**Phone Number:** 907-250-2541

## Additional Authorized Users

---

Legal Name	Relation with Applicant
Daniel N. Bellerive of Carlson Law Group LLC	Legal Counsel

---

## Registered Agent Information

---

<b>Name</b>	Charles Jackson
<b>Agent's Phone Number</b>	907-250-2541
<b>Agent's Email</b>	railwaycantina@yahoo.com
<b>Address</b>	1120 East Huffman, Ste 24 Pmb 416, Anchorage, AK, 99515, USA
<b>The registered agent is either an individual resident of the state or a domestic corporation authorized to transact business in the state and whose business office is the same as the registered office?</b>	Yes

## Ownership / Principal Party Details

---

Principal Parent Entity	Principal Party	Role	%Ownership
Chattermark Llc	ZPA, Llc	Member	100
Chattermark Llc	Charles Jackson	Affiliate	

---

## Premises Address

---

**Address:** 220 4th Ave , Seward, AK, 99664, USA

**Does the proposed site include a valid street address?** Yes

## Basic Business information

---

**Business/Trade Name:** Chattermark

**What is your primary business at this location?** Restaurant

## Local Government and Community Council Details

---

**City/Municipality** Seward

**Borough** Kenai Peninsula Borough

## Property Ownership

---

**Do you, the applicant, own the land, building, and/or warehouse at this proposed licensed location?** No

**Property Utilization Status** An Existing Facility

**Are you operating under?** Lease

**Add Copy of Lease\Sublease document** [Proof of right. title. interest. lease.pdf](#)

## Premises Diagram

---

**Will the license or permit embrace the entire premises address?** Yes

**Premises Diagram**

- [AB-02.pdf](#)

## Seasonal Information

---

**Are you conducting seasonal business?** Yes

**Please Provide your six-month operating period** 4/15-10/14

**Operation Period Details** Seasonal only

## Restaurant Detail

---

**Dining after standard closing hours: AS 04.16.010(c)** No

**Dining by persons 16 – 20 years of age: AS 04.16.049(a)(2)** Yes

**Dining by persons under the age of 16 years, accompanied by a person over the age of 21: AS 04.16.049(a)(3)** Yes

**Employment for any persons under 21 years of age: AS 04.16.049(c)** Yes

**List where within the premises minors are anticipated to have access in the course of either dining or employment. (Example: Minors will only be allowed in the dining area. OR Minors will only be employed and present in the Kitchen.)**

Minors will only be allowed in the dining area OR minors will only be employed and present in the kitchen

**Describe the policies, practices and procedures that will be in place to ensure that minors do not gain access to alcohol while dining or employed at your premises.**

Alcohol is stored behind the counter and is always served by someone over 21. Also always a manager present to oversee operations.

**Is an owner, manager, or assistant manager who is 21 years of age or older always present on the premises during business hours?** Yes

## Food Service Permit

---

**Is your license located in Municipality of Anchorage?** No

**Do you have Approved food service permit for this premises?** Yes

**Copy of the current food service permit for this premises OR the plan review approval.** [DEC food service permits.pdf](#)

# Entertainment & Service

---

**Are any forms of entertainment offered or available within the licensed business or within the proposed licensed premises?** No

**Food and beverage service offered or anticipated is:** Table Service

# Restaurant Declaration

---

**Please upload the finalized or expected Food and Alcohol Menu.** [Menu.pdf](#)

There are tables or counters at my establishment for consuming food in a dining area on the premises. I have included with this form a menu, or an expected menu, listing the meals to be offered to patrons.

This menu includes entrées that are regularly sold and prepared by the licensee at the licensed premises.

I certify that the license for which I am requesting designation is either a Beverage Dispensary, Beverage Dispensary Tourism, Club, Sporting Activity or Event License, Outdoor Recreation Lodge, Golf Course, Destination Resort, OR Restaurant or Eating Place, Seasonal REPL Tourism License.

# Hours Of Operation

---

<b>Sunday</b>	11:00 AM - 10:00 PM
<b>Monday</b>	11:00 AM - 10:00 PM
<b>Tuesday</b>	11:00 AM - 10:00 PM
<b>Wednesday</b>	11:00 AM - 10:00 PM
<b>Thursday</b>	11:00 AM - 10:00 PM
<b>Friday</b>	11:00 AM - 10:00 PM
<b>Saturday</b>	11:00 AM - 10:00 PM

# Other licenses involvement

---

ZPA LLC is the sole member of Howling Worlf Brewpub, LLC. Howling Worlf Brewpub, LLC, holds Beverage Dispensary- Seasonal license no. 4747. ZPA LLC is applying for a controlling intrest transfer of REPL-Seasonal license no. 5040 from Charles Jacksona nd Toni Strauss to become the sole member of Chattermark, LLC. ZPA LLC is additionally applying for a controling interest transfer of REPL-Seasonal license no. 4915 from Charles E. Jackson to become the sole membre of Taco Dans LLC.

## Financial Interest

---

I hereby certify that no person other than a proposed licensee listed on the liquor license application has a direct or indirect financial interest, as defined in AS 04.11.450(f) in the business for which a liquor license is being applied for.

I hereby certify that any ownership change shall be reported to the board as required under AS 04.11.040, AS 04.11.045, AS 04.11.050, and AS 04.11.055.

## Public Notice Posting Attestation and Publishers Affidavit

---

<b>Have you posted your application at both required locations for ten consecutive days?</b>	Yes
<b>What was the other conspicuous location of your post? (Please Include the full address)</b>	Seward Post Office
<b>What was the first day you posted your application?</b>	09/17/2024

I attest that I have met the public posting notice requirement set forth under AS 04.11.310 by posting a copy of my application for the 10-day period at the location of the proposed licensed premises and at another conspicuous location in the area of the proposed premises as listed in this application.

I hereby attest that I am the person herein named and subscribing to this application and that I have read the complete application, and I know the full content thereof. I declare that all of the information contained herein, and evidence or other documents submitted are true and correct. I understand that any falsification or misrepresentation of any item or response in this application, or any attachment, or documents to support this application, is sufficient grounds for denying or revoking a license/permit. I further understand that it is a Class A misdemeanor under Alaska Statute 11.56.210 to falsify an application and commit the crime of unsworn falsification.

## Attestations

---

I certify that all proposed licensees (as defined in AS 04.11.260) and affiliates have been listed on this application.

I certify that I understand that providing a false statement on this form or any other form provided by AMCO is grounds for rejection or denial of this application or revocation of any license issued.

I certify that all licensees, agents, and employees who sell or serve alcoholic beverages or check the identification of a patron will complete an approved alcohol server education course, if required by AS 04.21.025, and, while selling or serving alcoholic beverages, will carry or have available to show a current course card or a photocopy of the card certifying completion of approved alcohol server education course, if required by 3 AAC 305.700.

I agree to provide all information required by the Alcoholic Beverage Control Board in support of this application.

I hereby certify that I am the person herein named and subscribing to this application and that I have read the complete application, and I know the full content thereof. I declare that all of the information contained herein, and evidence or other documents submitted are true and correct. I understand that any falsification or misrepresentation of any item or response in this application, or any attachment, or documents to support this application, is sufficient grounds for denying or revoking a license/permit. I further understand that it is a Class A misdemeanor under Alaska Statute 11.56.210 to falsify an application and commit the crime of unsworn falsification.

I certify that all proposed licensees have been listed with Division of Corporation, Business, and Professional Licensing.

I certify that I and any individual identified in the business entity ownership section of this application, has or will read AS 04 and its implementing regulations.

I certify I have provided a menu of a variety of types of food appropriate for meals that are prepared on the licensed premises.

I certify that non-employees under 21 years of age will not enter and remain on the licensed premises except for the purposes of dining only.

I certify that the sale and service of food and alcoholic beverages and any other business on the licensed premises is under the sole control of the licensee.

I certify the licensed premises is a bona fide restaurant as defined in AS 04.21.080(b).

I certify there is supervision on the licensed premises adequate to reasonably ensure that a person under 21 years of age will not gain access to alcoholic beverages.

## Signature

---

Electronic Signature not collected; application submitted based on paper form.

# Payment Info

---

Payment Type : Check

Check Number: 100945658

Payment Date: 10/30/2023 12:00:00 AM

## Documents

---

#	File Name	Type	Added On
1	<a href="#">Proof of right. title. interest. lease.pdf</a>	License Lease\Sublease document	04/02/2025 07:58 AM
2	<a href="#">AB-02.pdf</a>	License Location Diagram Document	04/02/2025 07:59 AM
3	<a href="#">DEC food service permits.pdf</a>	LicenseRestaurantDetailFoodServicePermitDocumen t	04/02/2025 08:03 AM
4	<a href="#">Menu.pdf</a>	LicenseRestaurantDeclarationFoodAlcoMenuDocume nt	04/02/2025 08:04 AM
5	<a href="#">AB-11.pdf</a>	Signed Creditors Affidavit	04/02/2025 08:05 AM
6	<a href="#">AB-09.pdf</a>	Misc. documents to support the transfer application	04/02/2025 08:05 AM
7	<a href="#">Signed removal of Toni Strauss from application.pdf</a>	Misc. documents to support the transfer application	04/02/2025 08:05 AM
8	<a href="#">AB-08a Charles E. Jackson Jr._Redacted.pdf</a>	Misc. documents to support the transfer application	04/02/2025 08:05 AM
9	<a href="#">Entity Docs.pdf</a>	Misc. documents to support the transfer application	04/02/2025 08:05 AM
10	<a href="#">AB-07 + Publishers Affidavit.pdf</a>	Publishers Affidavit	04/02/2025 08:10 AM
11	<a href="#">AB-01.pdf</a>	License Paper Form Application Document	04/02/2025 08:10 AM







## Alaska Alcoholic Beverage Control Board Form AB-02: Premises Diagram

### Why is this form needed?

A detailed diagram of the proposed licensed premises is required for all liquor license applications, per AS 04.11.260 and 3 AAC 304.185. Your diagram must include dimensions and must show all entrances and boundaries of the premises, walls, bars, fixtures, and areas of storage, service, consumption, and manufacturing. If your proposed premises is located within a building or building complex that contains multiple businesses and/or tenants, please provide an additional page that clearly shows the location of your proposed premises within the building or building complex, along with the addresses and/or suite numbers of the other businesses and/or tenants within the building or building complex.

**The second page of this form may not be required.** Blueprints, CAD drawings, or other clearly drawn and marked diagrams may be submitted in lieu of the second page of this form. The first page must still be completed, attached to, and submitted with any supplemental diagrams. An AMCO employee may require you to complete the second page of this form if additional documentation for your premises diagram is needed.

**This form must be completed and submitted to AMCO's Anchorage office before any license application will be considered complete.**

Yes No

I have attached blueprints, CAD drawings, or other supporting documents in addition to, or in lieu of, the second page of this form.

### Section 1 – Establishment Information

Enter information for the business seeking to be licensed, as identified on the license application.

Licensee:	Chattermark, LLC	License Number:	5040		
License Type:	REPL - Seasonal				
Doing Business As:	Chattermark				
Premises Address:	220 4th Avenue				
City:	Seward	State:	Alaska	ZIP:	99664



Alcohol and Marijuana Control Office  
550 W 7<sup>th</sup> Avenue, Suite 1600  
Anchorage, AK 99501  
[alcohol.licensing@alaska.gov](mailto:alcohol.licensing@alaska.gov)  
<https://www.commerce.alaska.gov/web/amco>  
Phone: 907.269.0350

Alaska Alcoholic Beverage Control Board

## Form AB-02: Premises Diagram

---

### Section 2 – Detailed Premises Diagram

Clearly indicate the boundaries of the premises and the proposed licensed area within that property. Clearly indicate the interior layout of any enclosed areas on the proposed premises. Clearly identify all entrances and exits, walls, bars, and fixtures, and outline in red the perimeter of the areas designated for alcohol storage, service, consumption, and manufacturing. Include dimensions, cross-streets, and points of reference in your drawing. You may attach blueprints or other detailed drawings that meet the requirements of this form.

STATE OF ALASKA  
ALCOHOL BEVERAGE CONTROL BOARD  
Licensed Premises Diagram

**INSTRUCTIONS:** Draw a detailed floor plan of your present or proposed licensed premises on the graph below; show all entrances and exits, and all fixtures such as tables, booths, games, counters, bars, coolers, stages, etc.

DBA: Chattermark

PREMISES LOCATION: 220 4th Ave Seward, AK

Indicate scale by x after appropriate statement or show length and width of premises. \_\_\_\_\_ 1 SQ. = 4 FT.

SCALE A: X 1 SQ. = 1 FT. SCALE B:

Length and width of premises in feet:

Outline the area to be designated for sale, service, storage, and consumption of alcoholic beverages in red.  
**DO NOT USE BLUE INK OR PENCIL ON THIS DIAGRAM.**

55 feet x 28.5 feet

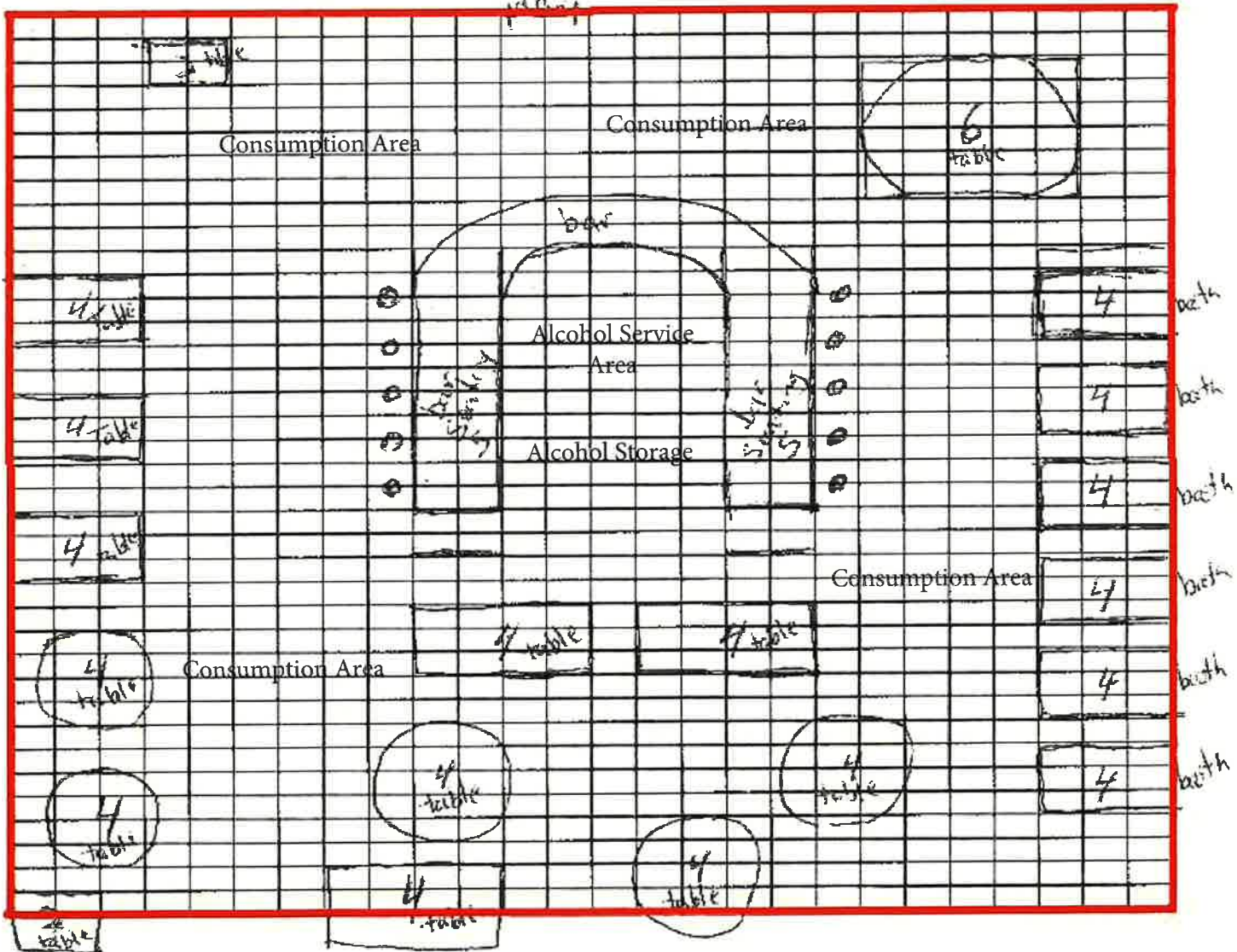



Chattermark Seward



### Chattermark Seward

4.2 ★★★★★ (561) - \$20-30  
Family restaurant ·   
Temporarily closed

Overview Reviews About

Directions Save Nearby Send to phone Share

A family-friendly seafood-focused menu in an easygoing setting with nautical decor & happy hour.

- 220 4th Ave, Seward, AK 99664
- Temporarily closed
- \$20-30 per person  
Reported by 207 people
- Menu  
sewardhospitalitygroup.com
- chattermark.biz
- (907) 224-4433
- 4H25+QV Seward, Alaska

Nearby restaurants Hotels Things to do Bars Coffee Takeout Groceries

Map labels include: The Tides Inn (4.3 ★ (92) 2-star hotel), Iris Vacation Rental, Apollo Restaurant (Greek), Rowdy Radish, Lone Chicharron Taqueria (Mexican), Seward Alehouse, Gold Rush Bistro (Temporarily closed), Wild Spoon (Temporarily closed), Hotel Seward (4.0 ★ (418) 2-star hotel), The Cookery Oyster Bar, Hotel Edgewater (3.9 ★ (387) 3-star hotel), Resurrection Bay Baptist Church, Seward Community Library & Museum, Resurrection Bay Historical Society, Northern Nights, Seward Parks & Recreation, and Chattermark Seward (marked with a red location pin).

Map controls: Layers, Google, Imagery ©2025 Airbus, CNES / Airbus, Maxar Technologies, Map data ©2025 United States Terms Privacy Send Product Feedback 50 ft



# CHATTERMARK

## APPETIZERS

**FRIES W/ DIPPING SAUCE** GF VG 11.00  
Plate of French Fries with 3 house dipping sauces: All American, CBS, and Southwest Pesto.

**SAUCY SALMON** 13  
Sockeye salmon deep fried and tossed in hot wing sauce.

**Chicken Wings** 15  
Seasoned chicken wings deep fried and tossed in our maple-chipotle hot sauce.

## SOUP AND SALADS

**MAPLE APPLE SALAD** GF VG 19  
Greens, apple slices, blue cheese crumbles, glazed walnuts, & housemade maple-vinaigrette.  
**Add: Halibut +21, Salmon+ 17 Patty +7**

**BLUE BERRY QUINOA SALAD** GF V VG 19  
Greens, quinoa, blueberries, pistachios, & housemade balsamic vinaigrette.  
**Add: Halibut +21, Salmon+ 17 Patty +7**

**REINDEER SAUSAGE SOUP** 14  
Reindeer sausage, potatoes, mushrooms, and spinach in a savory broth.  
**Add: Grilled Cheese Sandwich +6**

**SEAFOOD & SEAWEED CHOWDER** 16  
Local seafood in a creamy chowder.  
**Add: Grilled Cheese Sandwich +6**

## FISH AND CHIPS

**SIGNATURE FISH & CHIPS** 34  
A taste of Alaska with Salmon and Halibut deep fried in beer batter, served with fries and our signature southwest pesto sauce.

**ALL HALIBUT FISH & CHIPS** 42  
Halibut deep fried in beer batter, served with fries and our signature southwest pesto sauce

## BURGERS

served with french fries, sweet potato fries, or fresh carrots.  
All-American sauce: ketchup/mustard/pickle  
CBS sauce: chipotle/bbq/sour cream  
Southwest Pesto sauce: jalapeno/garlic/cilantro

**HALIBUT BURGER** 41  
Grilled Halibut fillet, jalapeño slaw, pickles, and garlic aioli on brioche bun.

**SALMON BURGER** 30  
Grilled Salmon fillet, pickled onions, and blueberry aioli on brioche bun

**THIN ICE BURGER** 16  
Hamburger with lettuce, tomato, onion, and All-American sauce on brioche bun.  
**Add: Cheese +2, Bacon +2, Egg +2**  
**Sub Veggie Patty +2**

**GLACIAL BLUE BURGER** 21  
Beef patty with bacon, blue cheese, & CBS sauce on brioche bun.  
**Sub Veggie Patty +2**

**SMOKEY BURGER** 22  
Beef patty, bacon, spicy onion, smoked gouda, & CBS sauce on brioche bun.  
**Sub Veggie Patty +2**

**CHATTERMARK BURGER** 22  
Beef patty, sautéed mushrooms/onion/garlic, swiss cheese, & CBS sauce on brioche bun.  
**Sub Veggie Patty +2**

**RING OF FIRE BURGER** 22  
Beef patty, sautéed mushroom/onion/garlic, jalapeños, swiss cheese, & southwest pesto sauce on brioche bun.  
**Sub Veggie Patty +2**

**FIRESTARTER BURGER** 22  
Beef patty, jalapeño, pepper-jack cheese, sriracha ketchup, southwest pesto sauce on brioche bun.  
**Sub Veggie Patty +2**



## KID'S MENU

CHILDREN UNDER 12 YEARS OLD  
served with carrots, apple slices, or french fries

**GRILLED CHEESE 10**

**CHICKEN NUGGETS 10**

**KID'S FISH & CHIPS 18**

**KID'S MAC & CHEESE 10**

## SOMETHING SWEET

**Brownie Sundae 12**

*(freshly made brownie, served with vanilla ice cream, topped with chocolate syrup)*

**S'mores in a Jar 12**

*(crackers crumbles, chocolate mousse and house made marshmallow)*

## SOFT DRINKS

**Soda 3**

*(coke, diet coke, dr. pepper, sprite, ginger ale,)*

**Honey Lemonades 5**

*(fresh made it, honeylemonade you can choose between pure, blueberry,raspberry or strawberry lemonade)*

**ICE TEA 3**

**COFFE OR TEA 3**

**Milkshake 10**

*(chocolate, strawberry or vanilla)*

**S'mores milkshake 12**

*(decorated with house-made marshmallow)*

## COMFORT FOOD

**MAC & CHEESE 22**

*Housemade creamy mac & cheese.*

**SEAFOOD MAC & CHEESE**

*Add a Grilled or Spicy Salmon or Halibut fillet to our housemade mac & cheese.*

**Salmon \$40; Halibut \$45**

**REINDEER MEATLOAF 26**

*Reindeer meatloaf, topped with roasted garlic spread and served with choice of garlic parmesan fries or mac & cheese.*

## BEERS

**TWISTER CREEK IPA 7,50**

**BEAVER TAIL BLONDE ALE 7.50**

**KASSIKS WHALER'S WHEAT 7.50**

**AGAVE GOLD 7,50**

## WINES

*(Glass/Bottles)*

**Reisling 11/30**

**Sauv. Blanc 11/30**

**Pinot Gris 11/30**

**Chardonnay 11/30**

**Cabernet Sauv 11/30**

**Pinot Noir 11/30**

**Merlot 11/30**

**Red Blend 11/30**





## Alaska Food Code 2025 Establishment Permit

Division of Environmental Health  
Food Safety & Sanitation Program

Permit Number: 5071  
Issued to: **Chattermark LLC**  
For: **CHATTERMARK**  
For Operation Of: **FF-1 Food Service**  
Located at: **220 4th AVE Seward, AK 99664**

This permit, issued under the provisions of 18 AAC 31, is valid until the noted expiration date or unless suspended or revoked by the department.

This permit is not transferable for change of ownership, facility location, or type of operation. It must be posted in plain view in the establishment and is the property of the State of Alaska.

Expiration Date:  
**December 31, 2025**

Program Manager:

A handwritten signature in black ink, appearing to read "Kimberly S. O'Neil".

**If you have questions or concerns regarding safe food handling practices call or text  
907-764-9825 or visit our website to file a complaint  
([dec.alaska.gov/eh/fss/report-illness-issue/](https://dec.alaska.gov/eh/fss/report-illness-issue/))**







## Alaska Food Code 2025 Establishment Permit

Division of Environmental Health  
Food Safety & Sanitation Program

Permit Number: 5072  
Issued to: **Chattermark LLC**  
For: **CHATTERMARK**  
For Operation Of: **FN-4 Tavern/Bar**  
Located at: **220 4th AVE Seward, AK 99664**

This permit, issued under the provisions of 18 AAC 31, is valid until the noted expiration date or unless suspended or revoked by the department.

This permit is not transferable for change of ownership, facility location, or type of operation. It must be posted in plain view in the establishment and is the property of the State of Alaska.

Expiration Date:  
**December 31, 2025**

Program Manager:

A handwritten signature in black ink, appearing to read "Kimberly S. O'Neil".

**If you have questions or concerns regarding safe food handling practices call or text  
907-764-9825 or visit our website to file a complaint  
([dec.alaska.gov/eh/fss/report-illness-issue/](http://dec.alaska.gov/eh/fss/report-illness-issue/))**

